



GWY-01
INSTALLATION MANUAL



GATEWAY

Further information can be found
in the Plejd app or at [plejd.com](https://www.plejd.com)

1 Connect the product

Connect Gateway to your local network via Ethernet and to a wall socket using the power adapter. A network cable and a power adapter are supplied in the box. Place Gateway within clear range of

your Plejd system, not in a closed metal cabinet. The product can be mounted with the accompanying wall bracket. Screws for the wall bracket are not included.

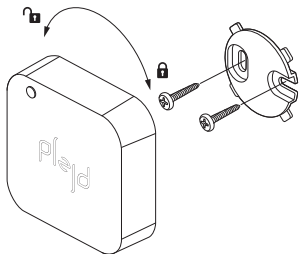
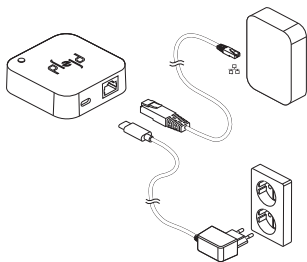

2 Follow the instructions in the app

Download the Plejd app on the App Store or Google Play. Open the app and follow the instructions to add Gateway

to your Plejd system. Setup requires Bluetooth® and an internet connection.

Power adapter (supplied*)

100-230 V ~50/60 Hz 0.2 A

Output voltage: +5V DC 1 A

USB-C

*Supplied with DVE Switching Adapter, model no. DSA-6PFG-05 FEU. Use only adapter listed.

Power consumption

0.6 W

External operating temperature

0 to +35 °C indoors

Dimensions

70x70x20 mm

LAN connection

Ethernet/RJ45

Radio

2.4 GHz mesh

Bluetooth®

<10 dBm

Radio range

Approx. 10 m indoors

The Plejd mesh technology extends the range by allowing the units to communicate with each other.

Pairing with HomeKit®

You can add Gateway to HomeKit in a few easy steps by using the Apple® Home app directly from your iPhone® or iPad®. Open the Apple Home app and follow the instructions for adding an accessory.

Discovery Mode

To pair with HomeKit, the product needs to be in Discovery Mode. Gateway is automatically in Discovery Mode for 10 minutes after startup. To manually enable Discovery Mode again, press the button on top of Gateway once.



Important information

Do not use the product if it has visible signs of damage. Clean the product with a dry cloth.



This electrical product should not be disposed of together with other household waste. Contact your local recycling center for guidance on electrical and electronic equipment disposal.

Support

In the event of any technical questions, please contact our customer service: support@plejd.com | +46 (0) 10 203 89 91

Compliant to standards

Hereby, Plejd AB declares that the radio equipment type GWY-01 is in compliance with Directive 2014/53/EU.

The full text of the EU declaration of conformity is available at the following internet address: plejd.com/compliance



Plejd AB

Krokslätts Fabriker 27A
431 37 Mölndal
Sweden

Manufacturer | Plejd AB
Country of manufacture | Sweden

Communication between iPhone®, iPad®, Apple Watch®, HomePod®, or Mac® and the HomeKit® enabled Gateway is secured by HomeKit technology.

Use of the Works with Apple® badge means that an accessory has been designed to work specifically with the technology identified in the badge and has been certified by the developer to meet Apple performance standards. Apple is not responsible for the operation of this device or its compliance with safety and regulatory standards.